

Congratulations, you have purchased the finest exhaust system available for your motorcycle. Your Vance & Hines exhaust is designed and crafted for performance, quality, and style. Please follow the instructions below, check exhaust system for missing or damaged parts and if you need any assistance please contact our technical support line (562) 921-7461.

FOR CLOSED COURSE COMPETITION USE ONLY. NOT INTENDED FOR STREET USE.

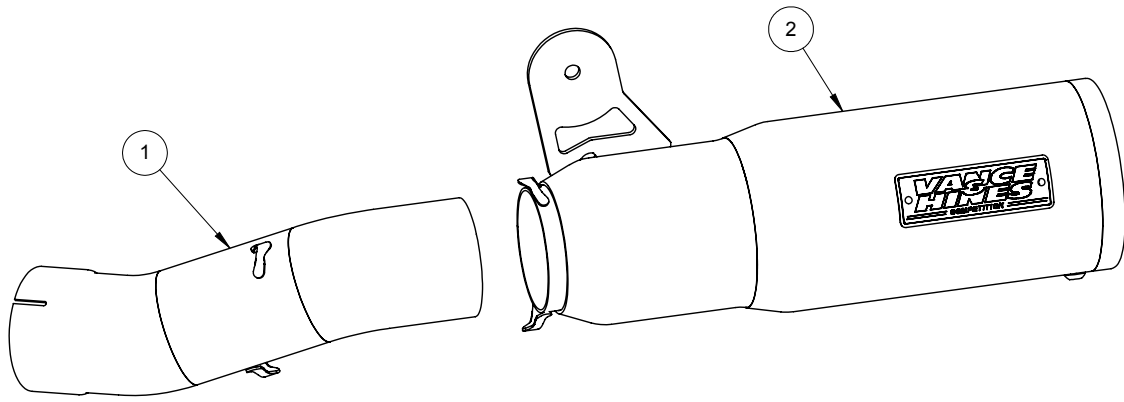

## HARDWARE

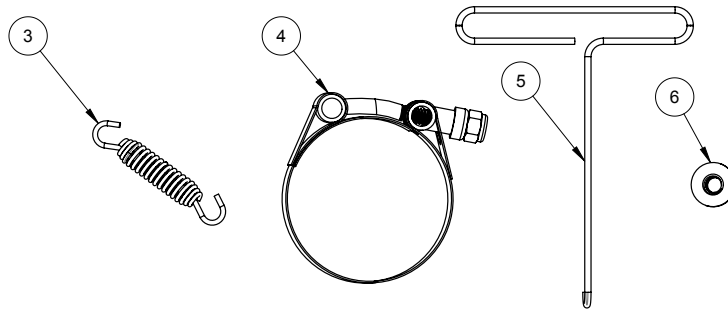

## PARTS LIST

ITEM NO.	PART NO.	DESCRIPTION	QTY.	ITEM NO.	PART NO.	DESCRIPTION	QTY.
1	B600RB	MID-PIPE	1	4	A925HW	2-5/16 - 2-5/8 T BOLT CLAMP	1
2	B610RB-S	MUFFLER CAN ASSEMBLY	1	5	A260SP	SPRING PULLER	1
3	A115SP	DIRT SPORT SPRING	2	6	A852HW	M8 X 1.25MM FLANGE NUT	1

## TOOLS REQUIRED



Wrenches: 10mm

Allen Wrench: T-45

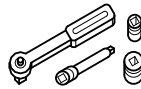

Sockets: 10mm

## STOCK SYSTEM REMOVAL

1. Loosen clamp securing muffler to head pipe.
2. Remove bolt securing muffler can to mount bracket.
3. Carefully slip muffler off of mid-pipe and set aside.

## VANCE & HINES SYSTEM INSTALLATION

1. Insert clamp (A925HW) onto the mid-pipe (B600RB) and position as shown in **Figure 1**.
2. Slip muffler (B610RB-S) onto mid-pipe (B600RB) and align spring clip tabs.
3. Slip mid-pipe onto stock header. **Note:** Mid-pipe must bottom out on head pipe collar. Adjust the fit of the muffler and secure muffler can using the stock mounting bolt and supplied flange nut (A852HW). Do not tighten at this time.
4. Align clamp with edge of midpipe, ensure mid-pipe slots are covered completely. Tighten clamp (A925HW) to secure mid-pipe in location.
5. Attach both exhaust springs (A115SP) to muffler and mid-pipe using supplied spring puller. **Figure 2**.

## EXHAUST CARE (STAINLESS)

1. When installing new stainless steel make sure your hands are clean and free of oil. After installation, thoroughly clean pipes and mufflers with a soft cloth and cleaning solvent that will leave no residue (acetone, glass cleaner, alcohol, etc...) before starting the motorcycle.
2. It is considered normal for stainless steel exhaust systems to discolor due to heat.
3. High performance engine tuning utilizing a dyno will likely result in severe discoloration.
4. Avoid long periods of idling as this can cause discoloration. Intake leaks can cause the engine to run lean and overheat; this could lead to discoloration.

**FIGURE 1**

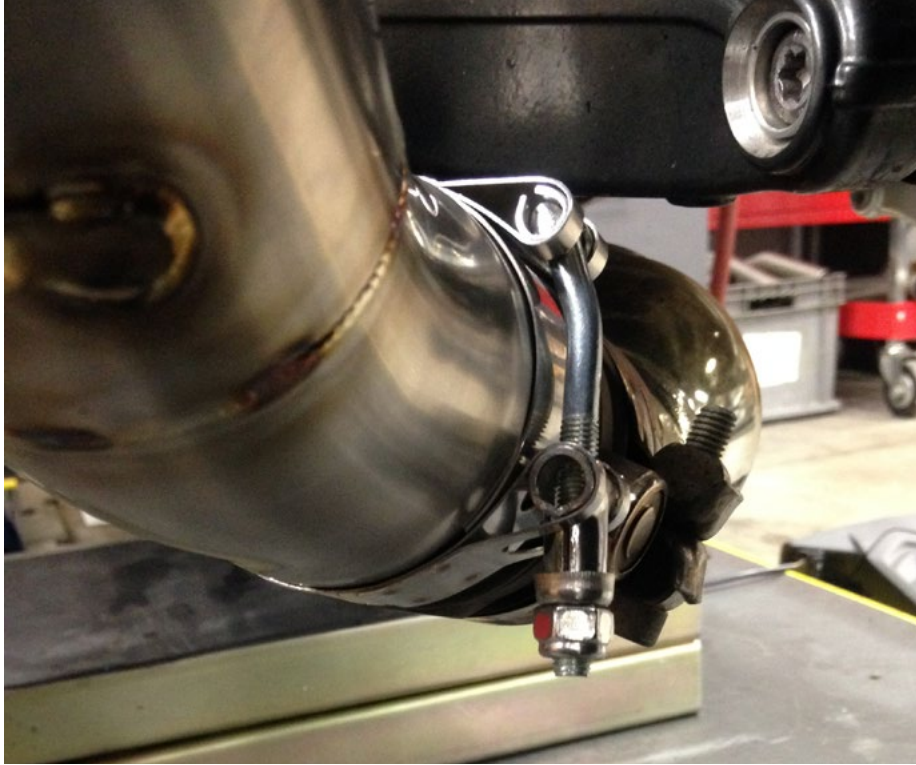

**FIGURE 2**



Emissions Notice:

In California, in order to meet Air Resources Board emissions requirements, certain aftermarket part applications have been identified as replacements, and others have received ARB Executive Orders. All other emissions related aftermarket parts are for competition use only. A list of replacement parts and EO parts, and corresponding fitment is provided at [vanceandhines.com/California](http://vanceandhines.com/California).

Warranty:

All Vance & Hines products are warranted against defects in material and workmanship for a period of 90 days. This warranty does not cover discoloration or rust. This warranty shall be limited to the repair or replacement of the product, which may be proven defective under normal use. Vance & Hines will not warranty any system that has been abused, misused, improperly installed or modified.

Dealers or distributors are not authorized to make dispositions binding upon Vance & Hines. Vance & Hines will not be responsible for any labor charges incurred in removing or replacing any system under warranty. A return authorization number and a copy of the original purchase invoice must accompany all returns. Parts returned without a return authorization may be refused.

13861 ROSECRANS AVENUE / SANTA FE SPRINGS, CA 90670  
SALES: (562) 921-5388  
TECHNICAL: (562) 926-5291  
FAX: (562) 802-0110

**vanceandhines**  
**.com**