

Congratulations, you have purchased the finest exhaust system available for your motorcycle. Your Vance & Hines exhaust is designed and crafted for performance, quality, and style. Please follow the instructions below, check exhaust system for missing or damaged parts and if you need any assistance please contact our technical support line (562) 921-7461.

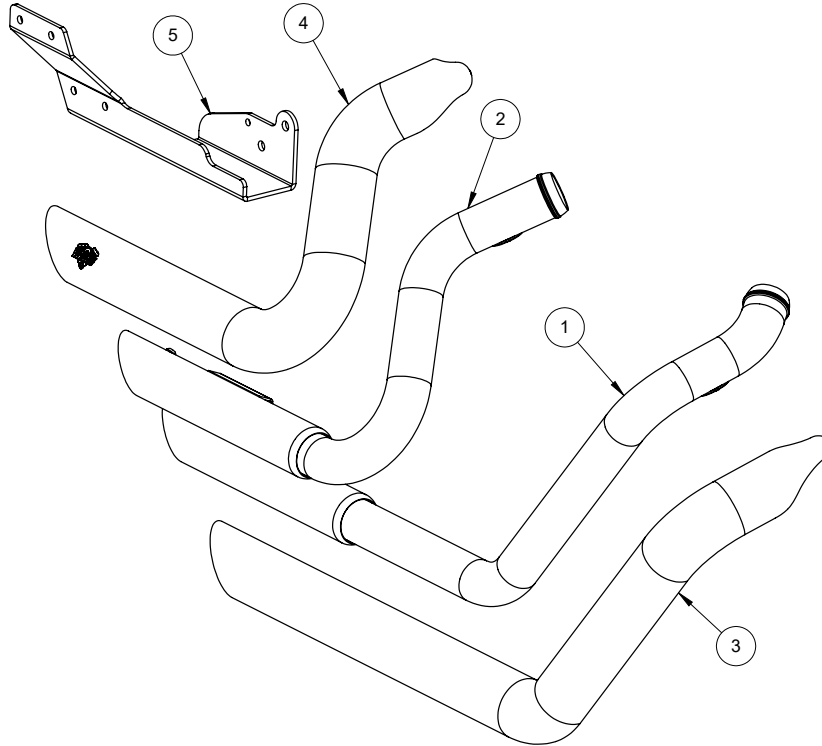

### PARTS LIST

NO.	PART NO.	Description	Qty.				
1	D786FC	Front Head Pipe	1	6	A195HW	Dogbone Nutplate	2
2	D787FC	Rear Head Pipe	1	7	A270HW	1.75" Hose Clamp	4
3	D786HC/D788HP	Front Heat Shield	1	8	A272HW	2.25" Hose Clamp	3
4	D787HC/D789HP-S	Rear Heat Shield	1	9	A240HW	5/16-18"X5/8" Flange Head Bolt	4
5	812-P	Mounting Bracket	1	10	A288HW	Nylon Cable Tie	1
				11	A644ST	18-12mm O2 Adaptor	2

## HARDWARE

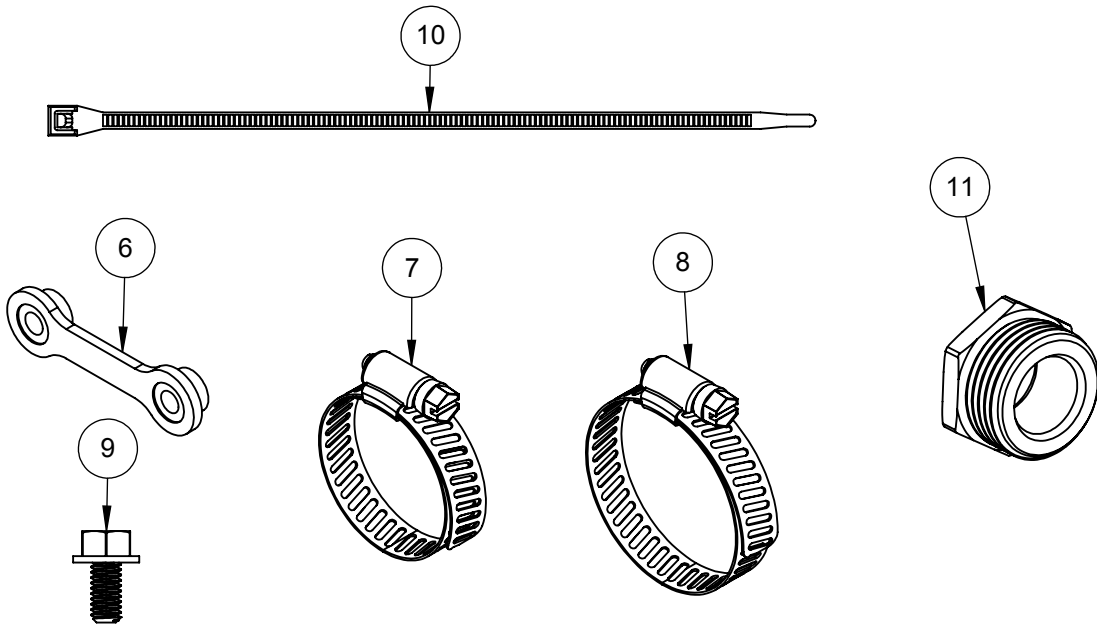

## TOOLS REQUIRED

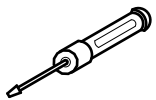

Flat Head Screwdriver

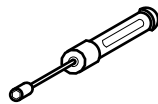

5/16 Nut Driver

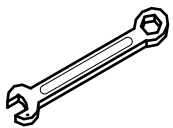

Combination Wrench:  
3/8", 1/2", 9/16",  
14mm, 19mm, 22mm

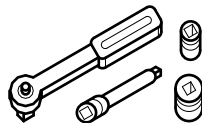

3/8" Drive Ratchet w/ 4"  
extension 1/2", 9/16" Deep  
Socket, 7/16" Deep Socket,  
3/8", 10mm, 19mm Socket

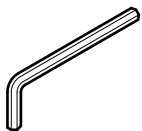

Allen Wrenches: 3/16",  
5/16", 10mm  
Torx: T30

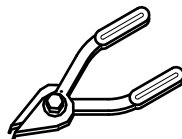

Snap Ring Pliers

## STOCK EXHAUST SYSTEM REMOVAL

1. If equipped, find and unplug the O2 sensor wires from the wiring harness. Feed the end of the wires through the frame so they are free from the motorcycle. Pay attention to the wire routing for re-installation.
2. Loosen the heat shield clamps on both the front and rear head pipes. This allows for easier access to the head pipe mounting nuts.
3. Remove the two head pipe mounting nuts from each flange, located at the cylinder head.
4. Remove the clamp bolts which mounts the rear head pipe to the belt drive cover bracket.
5. Remove the two bolts from each muffler body where they attach to the mounting bar. Carefully remove exhaust pipes from the motorcycle and set aside.
6. Remove the belt drive cover and take the bracket off the rear cover bolt, this bracket will not be reused.
7. Remove the e-clip from the brake rod lynch pin. Remove the right side rider foot controls.
8. Remove the three mounting bolts and washers attaching the exhaust mounting bar and save the hardware for reuse.
9. Carefully remove the O2 sensors from the stock head pipes and save them for reuse with the new system.
10. Carefully remove exhaust port flanges and circlips from the stock exhaust system using snapping pliers. Replace bent or damaged circlips.
11. Check exhaust port gasket condition and replace if necessary. Harley-Davidson part number: 65324-83B.

## VANCE & HINES EXHAUST INSTALLATION

1. Install the supplied mounting bracket, 812-P, using the stock washers and bolts. Hand tighten only at this time.
2. Using a leveling tool, level the mounting bracket, 812-P, to ensure that it is parallel with the frame. See **Figure 1**.
3. Torque the mounting bracket bolts to 30-33 Ft./Lbs.
4. Reinstall the drive belt cover. Torque the 3/8" bolt to 30-33 FT./Lbs. and the 1/4" bolts to 80-120 In./Lbs.
5. Re-install brake rod, brake rod lynchpin and e-clip. Re-install foot controls.
6. Remove head pipes and heat shields from their protective packaging. Place each heat shield on a non-abrasive surface such as a blanket or carpet. Using a pencil, lightly mark outside edge of each heat shield to show location of mounting clips where hose clamps will loop through. NOTE: Pencil marks can be erased if care is taken not to harm coating.
7. Lay the head pipes into heat shields and loosely install hose clamps by feeding tail end of the hose clamps into heat shield clips. Take note of screw head direction. **Figure 2**. Screw heads should be accessible when system is installed on motorcycle for adjustment purposes.
8. Apply a small amount of anti-seize compound to the threads of the O2 sensors and install them into the new head pipe. Install supplied 18mm to 12mm oxygen sensor adapter then install 12mm oxygen sensors.
9. Install the exhaust port flanges and circlip from the stock system onto the new head pipes.
10. Using stock flange nuts, carefully install the head pipes into exhaust ports. Do not tighten the nuts at this time.
11. Slide nut plates inside brackets welded to backside of muffler bodies. **Figure 3**. While holding nut plates in place, attach muffler bodies to mounting bracket 812-P using four 5/16" x 5/8" flange head bolts (supplied). Leave them loose at this time.
12. Tighten cylinder port exhaust flange nuts on front and rear cylinders while making sure pipes are parallel.
13. Tighten the flange bolts on both mufflers.
14. Tighten all heat shield clamps. NOTE: Muffler bodies should protrude from heat shields by an equal amount on both pipes. **Figure 4**.
15. Plug O2 sensors back into wiring harness and route wires away from hot areas of motorcycle.
16. Install a new nylon cable tie (supplied) to hold the front wire onto the frame in the original location.
17. Check for adequate clearance of all exhaust system components and motorcycle accessories prone to heat damage.
18. Be sure to tighten all hardware before starting motorcycle.

FIGURE 1

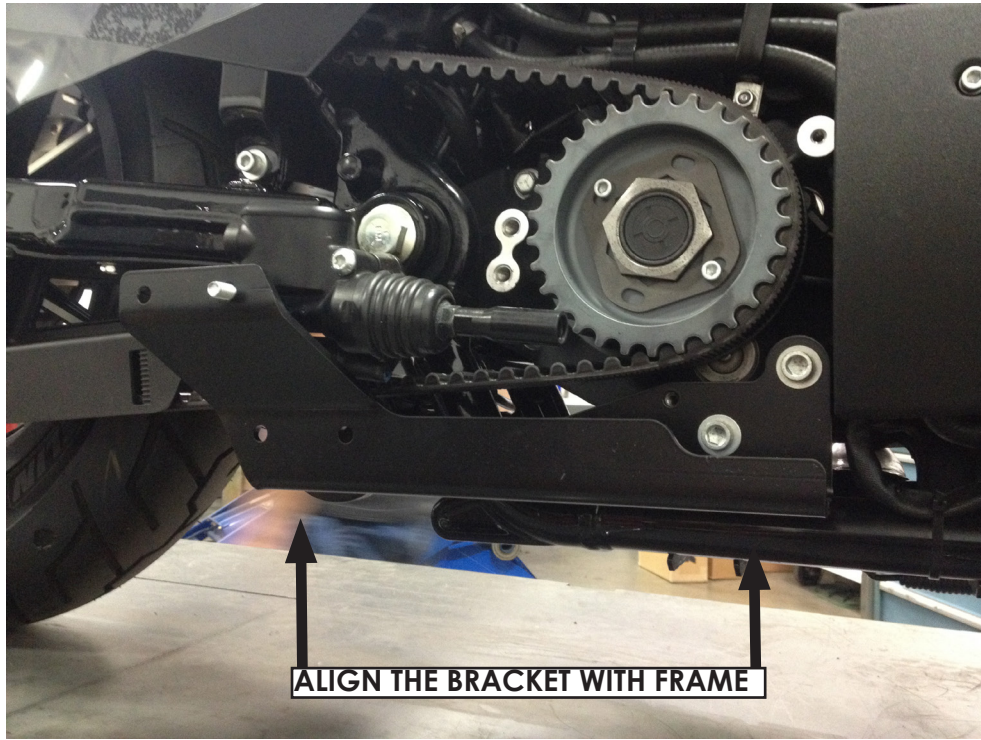
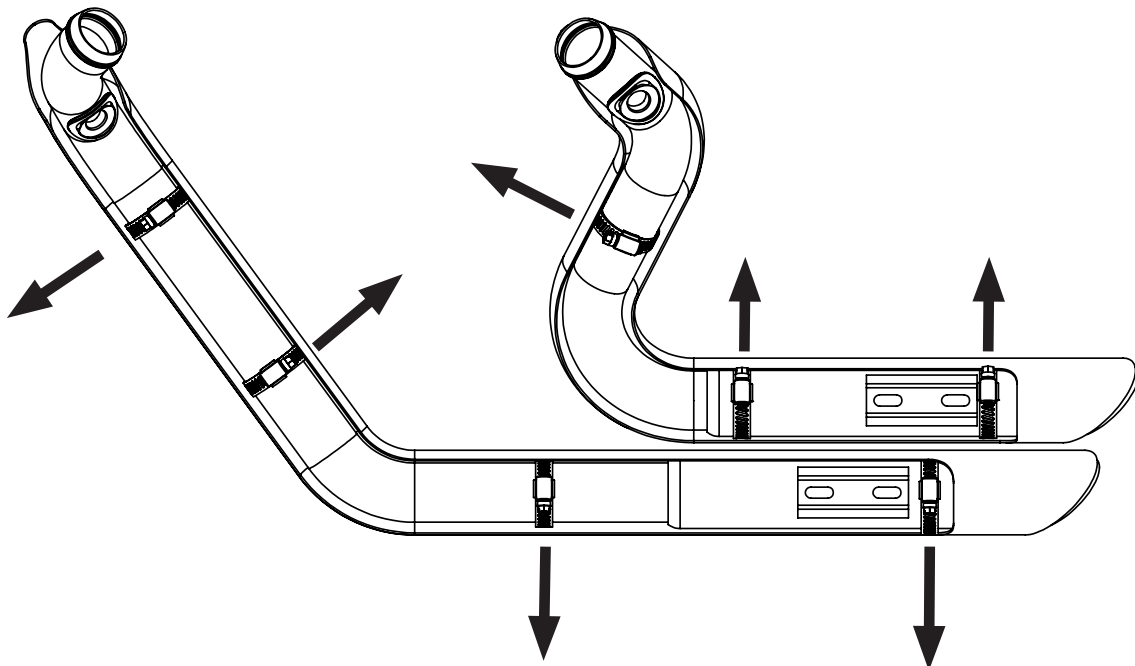
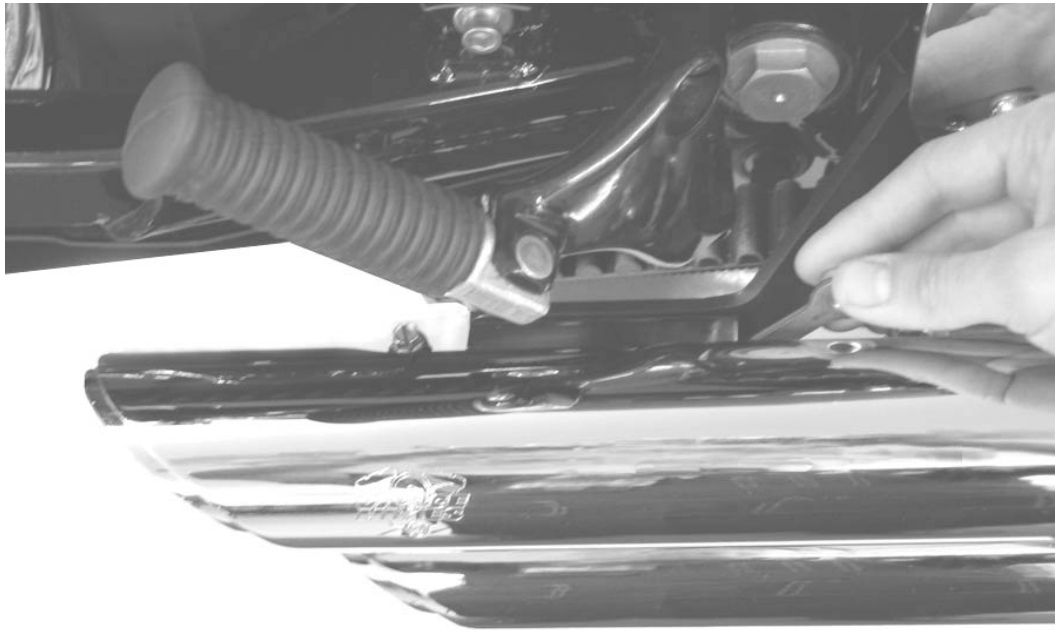

FIGURE 2

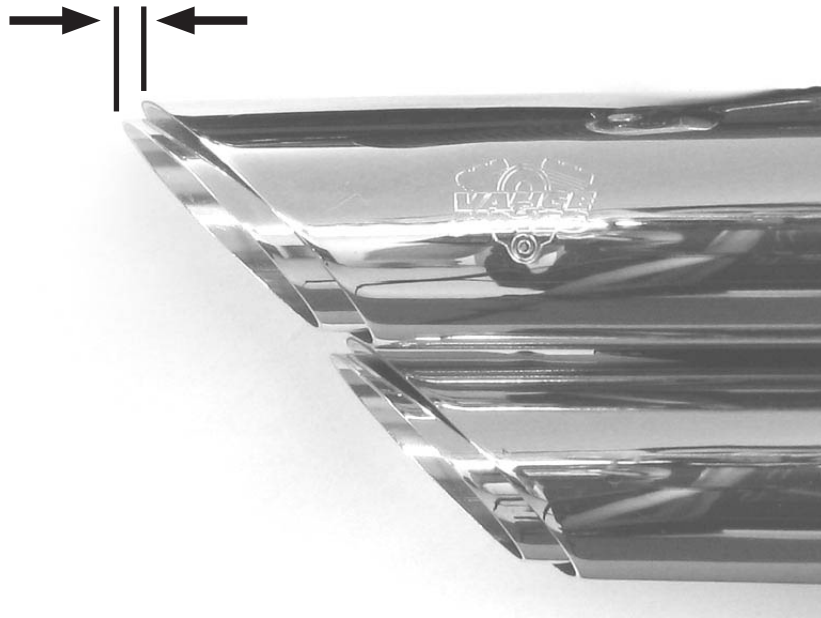

**FIGURE 3**



Install nut plate

**FIGURE 4**



Muffler protrudes an equal amount on both pipes

Emissions Notice:

In California, in order to meet Air Resources Board emissions requirements, certain aftermarket part applications have been identified as replacements, and others have received ARB Executive Orders. All other emissions related aftermarket parts are for competition use only. A list of replacement parts and EO parts, and corresponding fitment is provided at [vanceandhines.com/California](http://vanceandhines.com/California).

Warranty:

All Vance & Hines products are warranted against defects in material and workmanship for a period of 90 days. This warranty does not cover discoloration or rust. This warranty shall be limited to the repair or replacement of the product, which may be proven defective under normal use. Vance & Hines will not warranty any system that has been abused, misused, improperly installed or modified.

Dealers or distributors are not authorized to make dispositions binding upon Vance & Hines. Vance & Hines will not be responsible for any labor charges incurred in removing or replacing any system under warranty. A return authorization number and a copy of the original purchase invoice must accompany all returns. Parts returned without a return authorization may be refused.

13861 ROSECRANS AVENUE / SANTA FE SPRINGS, CA 90670  
SALES: (562) 921-5388  
TECHNICAL: (562) 926-5291  
FAX: (562) 802-0110

**vanceandhines**  
**.com**